



5/19 Reckleben Street Castlemaine VIC

2 1 1

This two-bedroom, two-storey, corner townhouse with an 8-star plus energy-efficiency rating has an ethos of sustainability, community, and self-sufficiency.

Welcome to The Paddock, a unique community-orientated project where the buildings, designed for the future, embody the highest standards in environmental design. The Paddock offers the opportunity to practice a sustainable lifestyle in a like-minded community.

Enjoy the privacy of your home with the option of joining in shared social and communal activities and making the most of your shared ownership of the community house and 1.5 hectares of grounds and gardens. The Paddock is within walking distance or a short drive to the centre of Castlemaine, the train station and the Castlemaine Botanical Gardens.

Price : \$769,000
Building Size : 84 sqm
View : <https://www.cantwellproperty.com.au/sale/vic/greater-bendigo-region/castlemaine/residential/house/7908240>



Nick Haslam
03 5472 1133



Megan Walmsley
03 5472 1133

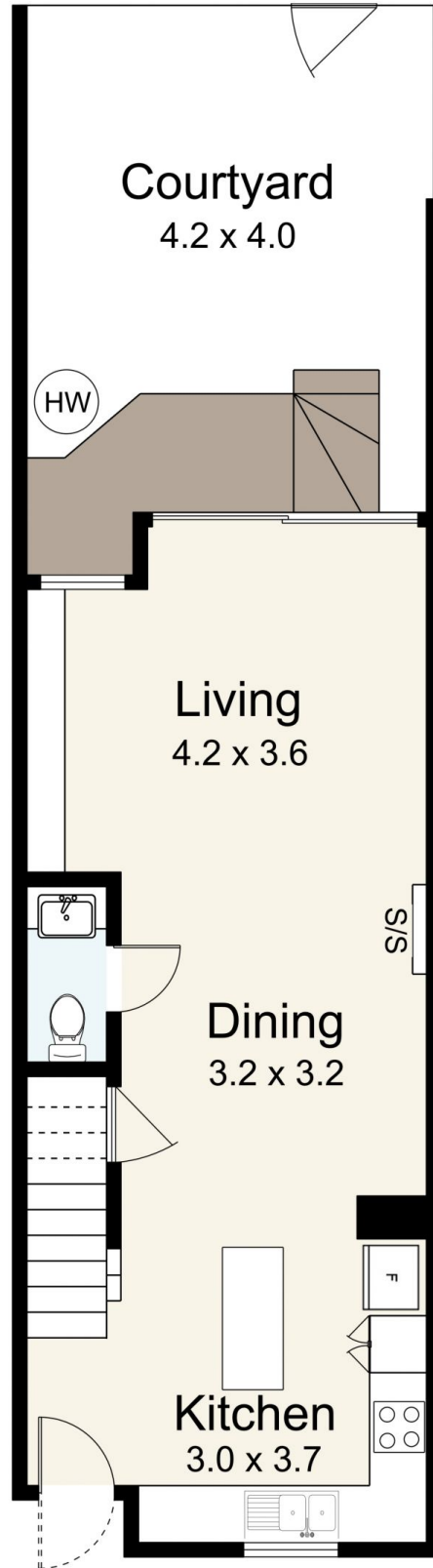
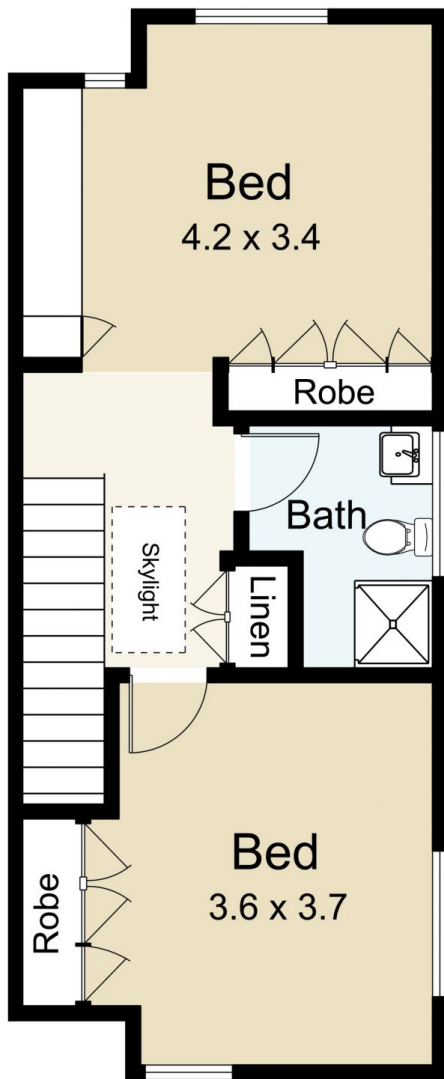

5/19 Reckleben Street, Castlemaine

SCALE UNIT IS IN METRES
 All measurements are approximate and for illustration purposes only. It should not be considered 100% accurate. Interested parties should rely on their own enquiries.

Residence - 84m²
 Courtyard/Deck - 22m²