



139 Fryers Road Campbells Creek VIC

5 2 3

Set behind custom-designed electric gates on approximately 8 acres at the very edge of the Castlemaine Diggings National Park, this five-bedroom brick home sits elevated and private, pulled back from the road as though it has always known its place in the landscape. To the rear, the bush simply begins, and with it, a daily chorus of native birds, the rustle of seasons changing, and the unhurried rhythm of a life lived well.

At the heart of the home is a generous open-plan living, dining and kitchen space that breathes. The kitchen is built to work: solid Jarrah cabinetry, gold-flecked granite benchtops, a freestanding Smeg gas cooktop and oven, Asko dishwasher, filtered kitchen tap and a walk-in pantry. The living room draws the eye immediately to its standout

Type : House
Price : \$1,450,000
Building Size : 218 sqm
Land Size : 8 Acres
View : <https://www.cantwellproperty.com.au/sale/vic/greater-bendigo-region/campbells-creek/residential/house/8696321>

[For full version visit the website](#)



Nick Haslam
03 5472 1122



Jeremy Bottomley
03 5472 1122

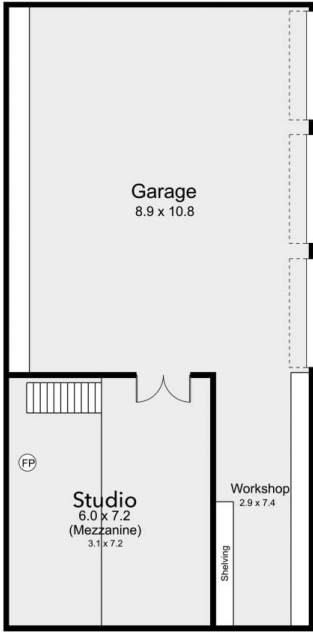

(Not Shown In Correct Location)



139 Campbells Creek - Fryers Road, Campbells Creek

SCALE UNIT IS IN METRES
 All measurements are approximate and for illustration purposes only. It should not be considered 100% accurate. Interested parties should rely on their own enquiries.

Residence - 218m²
 Garage/Studio - 179m²

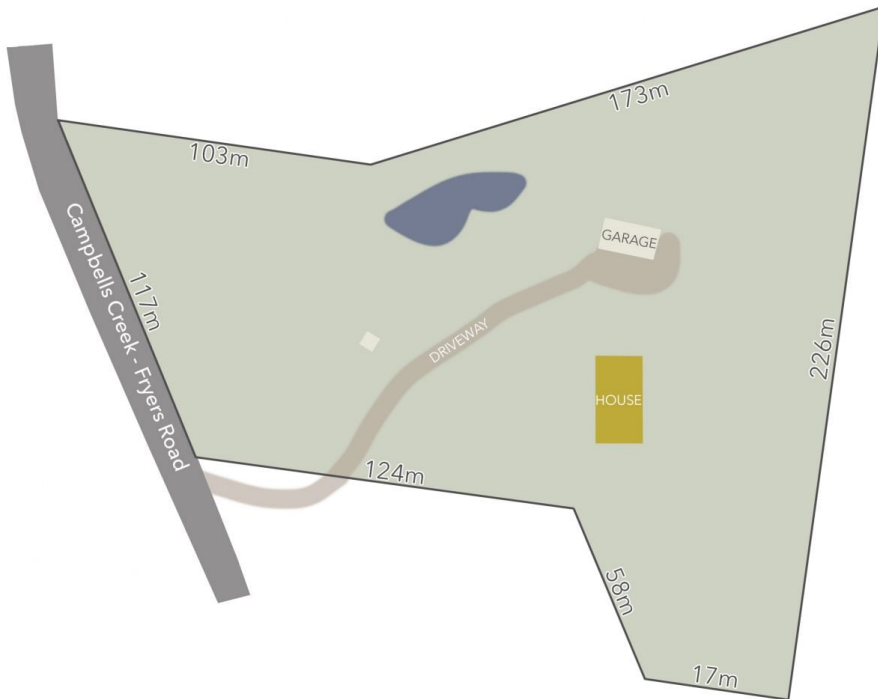

LAND AREA : 8.0Ac (APPROX)



139 Campbells Creek - Fryers Road, Campbells Creek

All Measurements & Details Shown Are Approximate Only.